



Comhairle Contae
Ros Comáin
Roscommon
County Council



TO: The Cathaoirleach and Each Member of Athlone Municipal District

**RE: Declaration of a Public Road
Roads Act 1993, Section 11
Roads Regulations 1994, Part 2
Local Government Reform Act 2014 Schedule 3**

Request for Private Road to be Taken-in-Charge: Sherlock's Road, Baylough, Athlone, Co. Roscommon

A request was received from the residents and landowners on a private road at Monksland, Athlone (known as Sherlock's Road) to be declared a public road. Where a road is declared a public road, the Council will be responsible for the future maintenance of the road. Drawings are attached showing the road requested to be taken in charge. The declaration of a road to be a public road is a reserved function to be performed by Municipal District Members under Schedule 3 of the Local Government Reform Act 2014.

In accordance with the Roads Act 1993 Section 11 (b) Roscommon County Council has considered the following:

(i) Satisfied itself that the road is of general public utility.

The lands adjacent to the road are mostly in the ownership of the Sherlock family and consist of small gardens. There are three houses located on the section of road within county Roscommon. The road has been examined by Roads and Transportation technical staff and is in very bad condition and may have being surface dressed at sometime in past.

Roscommon County Council has not satisfied itself that the road is of general public utility.

(ii) Considered the financial implications for the authority of the proposed declaration.

The level of funding required from Department of Tourism Transport and Sport is not adequate to address the maintenance of the existing public road network. Each case would need to be evaluated individually. The council should maintain its policy of not taking private roads in charge except in exceptional circumstances. The estimated cost of the works to be carried out on the road is €40,000 and the Council would also be charged with the future maintenance of the road. In this case the Roads Section considers it a prudent policy not to spend public monies on this private road.

I do not recommend the taking in charge of this section of road within Athlone Municipal District administrative area.

**Eugene Dwyer, Senior Engineer
Head of Roads and Transportation
8/3/2017.**

© Ordnance Survey Ireland. All rights reserved.
 Licence number 2010/18CCMA
 Roscommon County Council

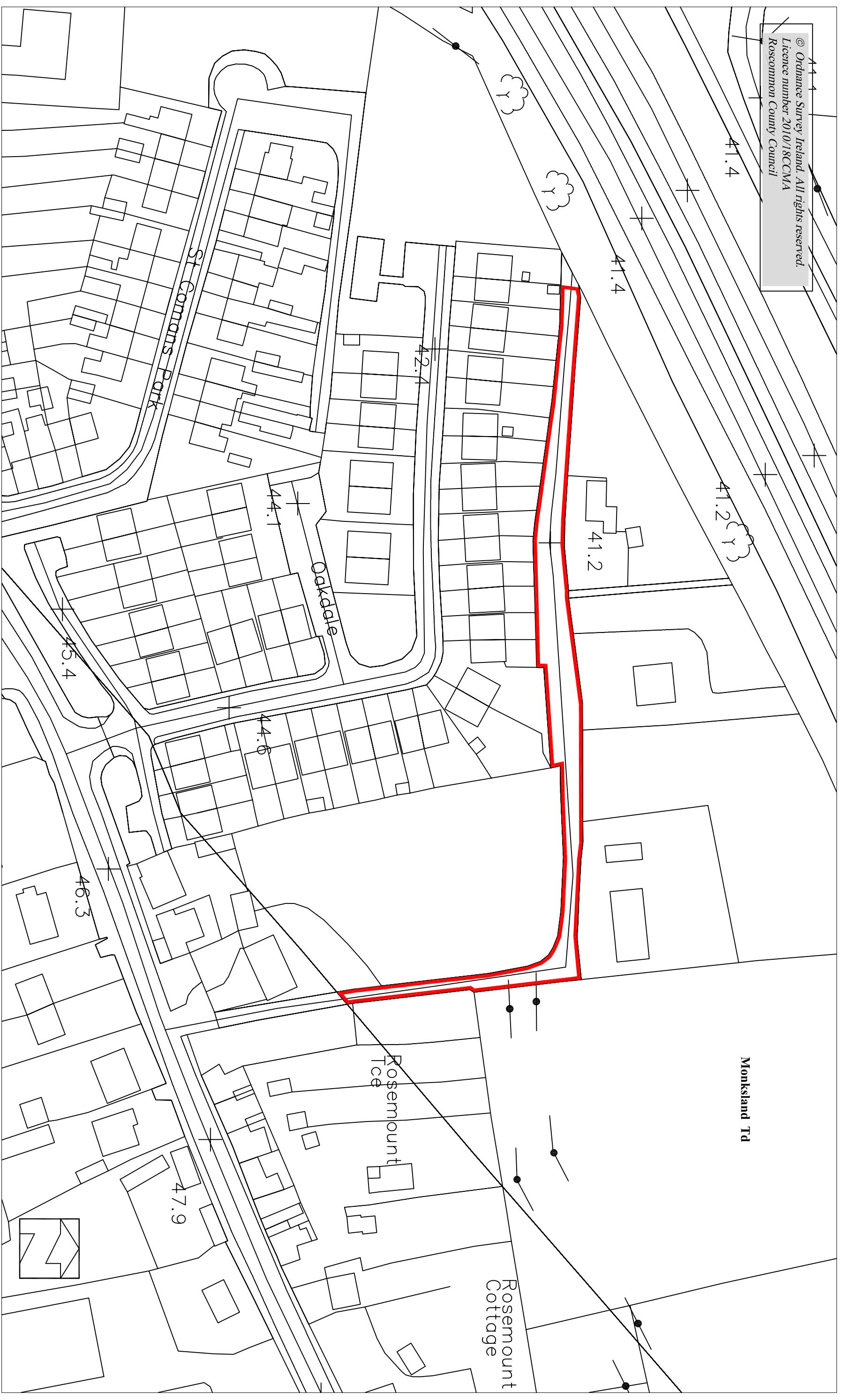

Monksland Td

Rosemount
Cottage

Rosemount
Terrace

St Comans Park

Oakdale

ROSCOMMON COUNTY COUNCIL

Road Design Section,
 Atras an Chonraí, Roscommon,
 Phone 090 66 37100
 C.E.O. and Director of Service: Mr. Eugene Cummins.



Area to be Taken In Charge



Map - Monksland Athlone.

Project:		Taken in Charge - "Monksland Athlone"		Drawing No.:	
Title:		Monksland, Athlone, Co Roscommon.			
Scale:	1:2500	Date:	07/03/2017	OS Map No.	3035-D, (tm co-ords)
Design:		Drawn:	B. Earley	Checked:	
				Contract:	

TO: The Cathaoirleach and Each Member of Athlone Municipal District

**RE: Declaration of a Public Road
Roads Act 1993, Section 11
Roads Regulations 1994, Part 2
Local Government Reform Act 2014 Schedule 3**

Request for Private Road to be Taken-in-Charge: Curraghgower, Ballinasloe, Co. Roscommon

A request was received from the resident and landowner on a private road at Curraghgower, Ballinasloe to be declared a public road. Where a road is declared a public road, the Council will be responsible for the future maintenance of the road. Drawings are attached showing the road requested to be taken in charge. The declaration of a road to be a public road is a reserved function to be performed by Municipal District Members under Schedule 3 of the Local Government Reform Act 2014.

In accordance with the Roads Act 1993 Section 11 (b) Roscommon County Council has considered the following:

(i) *Satisfied itself that the road is of general public utility.*

The private road has been examined by Roads and Transportation technical staff is approximately 200m in length and serves a dwelling house and farmlands

Roscommon County Council has not satisfied itself that the road is of general public utility.

(ii) *Considered the financial implications for the authority of the proposed declaration.*

The level of funding required from Department of Tourism Transport and Sport is not adequate to address the maintenance of the existing public road network. As the only benefit will be to the landowner the Engineer has recommended that the Council should maintain its prudent policy of not spending public monies on private roads. The estimated cost to bring this road to an acceptable standard is €15,000 and the Council would also be charged with the future maintenance of the road.

I do not recommend the taking in charge of this section of road within Athlone Municipal District administrative area.

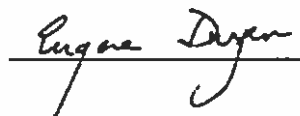

**Eugene Dwyer, Senior Engineer
Head of Roads and Transportation
8/3/2017.**

© Ordnance Survey Ireland. All rights reserved.
Licence number 2010/18CCMA
Roscommon County Council

AGHAWARRACAHILL TD

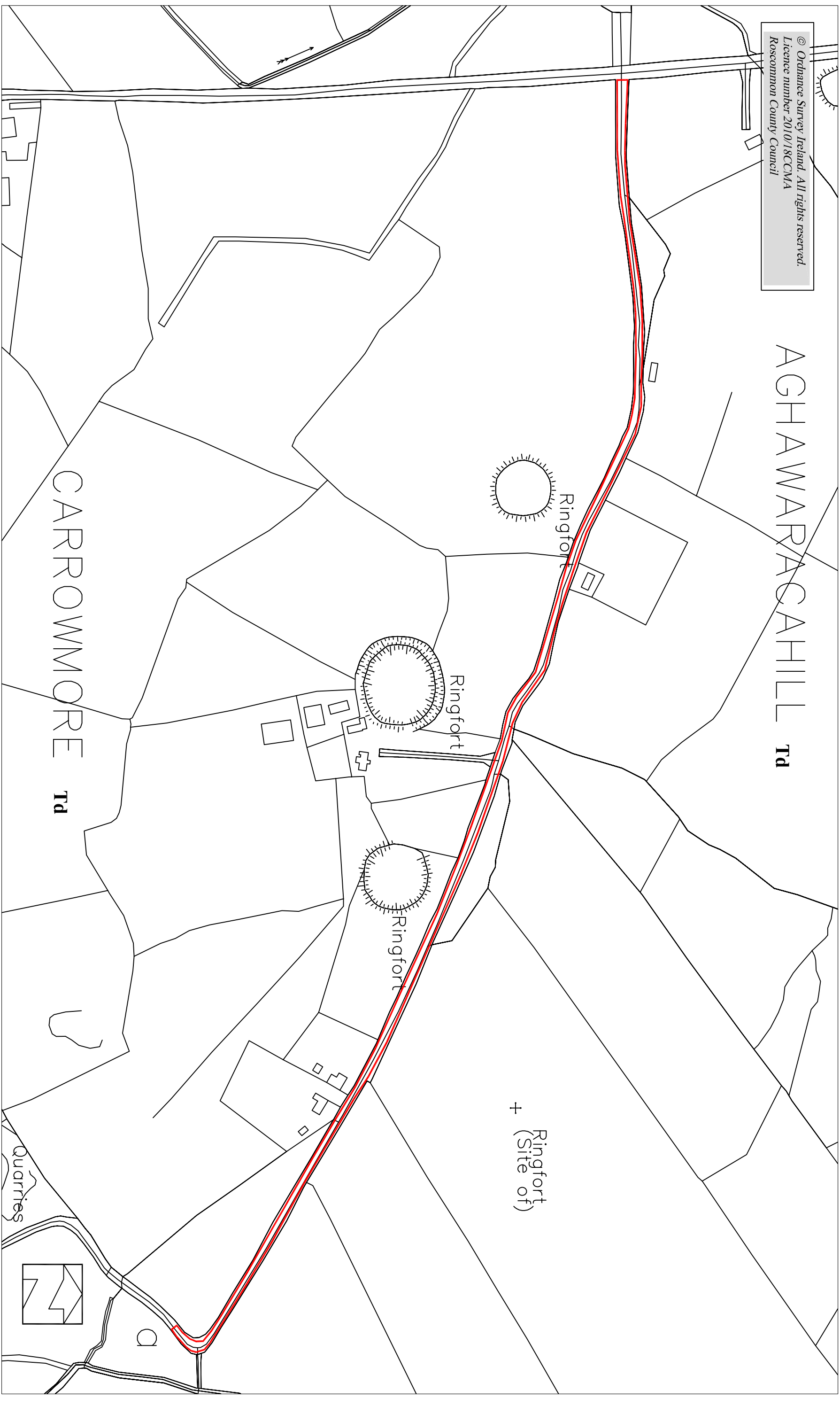

ROSCOMMON COUNTY COUNCIL

Road Design Section,
Aras an Chonrae, Roscommon,
Phone 090 66 37100
C.E.O. and Director of Service: Mr. Eugene Cummins.



Comhairle Contae
Ros Comáin
Roscommon
County Council



Area to be Taken In Charge



**Map - Carrowmore,
Hillstreet, Carrick-on-Shannon.**

Project: Taken in Charge, - "Carrowmore, Hillstreet Carrick-on-Shannon."			
Title: Carrowmore, Hillstreet Carrick-on-Shannon, Co Roscommon.			
Scale: 1:2500	Date: 08/03/2017	OS Map No.: 1926, (1m co-ords)	Drawing No.:
Design:	Drawn: B. Earley	Checked:	Contract:



Comhairle Contae
Ros Comáin
Roscommon
County Council



TO: The Cathaoirleach and Each Member of Athlone Municipal District

**RE: Declaration of a Public Road
Roads Act 1993, Section 11
Roads Regulations 1994, Part 2
Local Government Reform Act 2014 Schedule 3**

Request for Private Road to be Taken-in-Charge: Taylorstown, Clonoown, Athlone, Co. Roscommon.

A request was received from the residents and landowners on a private road in Taylorstown, Clonoown, Athlone to be declared a public road. Where a road is declared a public road, the Council will be responsible for the future maintenance of the road. A drawing is attached with photographs showing the road requested to be taken in charge.

In accordance with the Roads Act 1993 Section 11 (b) Roscommon County Council has considered the following:

(i) *Satisfied itself that the road is of general public utility.*

This road, is approximately 300m in length and an average of 30.6 in width. The road has a surface-dressed wearing course which needs attention. There are 7 inhabited houses on the road and access to four farms.

Roscommon County Council has satisfied itself that the former public road is of general public utility.

(ii) *Considered the financial implications for the authority of the proposed declaration.*

The level of funding required from Department of Tourism Transport and Sport is not adequate to address the maintenance of the existing public road network. Each case would need to be evaluated individually. The council should maintain its policy of not taking private roads in charge except in circumstances where it is not reasonable to expect the road users to maintain the road from their own resources. In such a scenario the Roads Section considers it a prudent policy not to spend public monies on private roads. However, this road has a good foundation and a thin layered Dense Bitumen Macadam, DBM, should prevent major maintenance issues for 10 years. The estimate cost of the works to be carried out on the road is €30,000. The Council will be charged with the future maintenance of the road.

I recommend that the procedure in accordance with Section 11 of the Roads Act 1993 and Part 2 of the Roads Regulations 1994 be commenced to declare this road a public road. The declaration of a road to be a public road is a reserved function to be performed by Municipal District Members under Schedule 3 of the Local Government Reform Act 2014.

**Eugene Dwyer, Senior Engineer
Head of Roads and Transportation
13/3/2017.**



Photographs of Private Road at Taylorstown Cloonown, Athlone, Co. Roscommon



© Ordnance Survey Ireland. All rights reserved.
Licence number 2010/18CCMA
Roscommon County Council

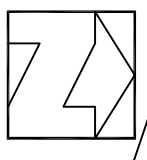
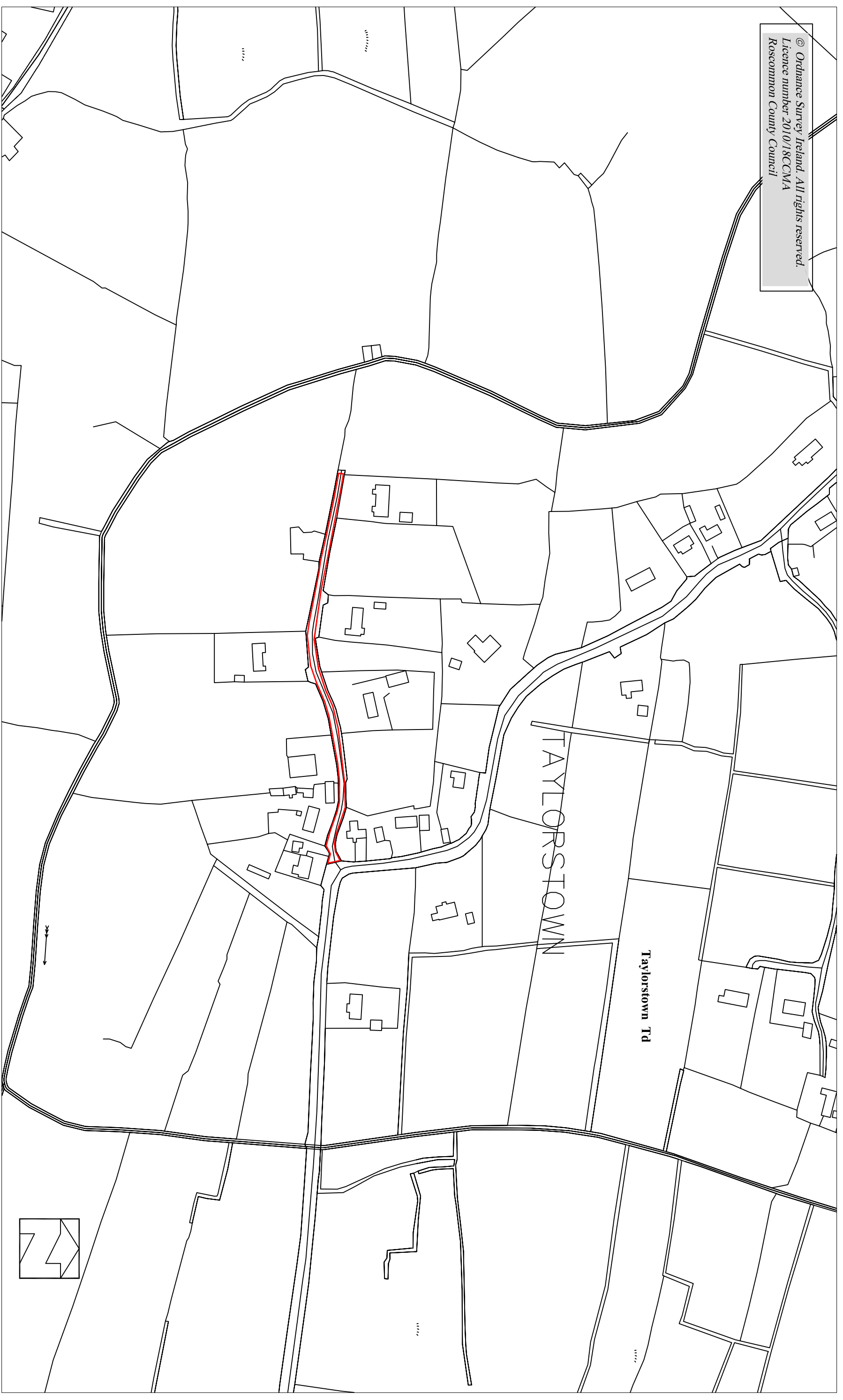

Area to be Taken In Charge



Map - Taylorstown Cloonown Athlone.

Project: Taken in Charge, - "Taylorstown Cloonown Athlone"			
Title: Taylorstown, Cloonown, Athlone, Co Roscommon.			
Scale: 1:2500	Date: 07/03/2017	OS Map No: 3169, (1m co-ords)	Drawing No.:
Design:	Drawn: B. Earley	Checked:	Contract:



ROSCOMMON COUNTY COUNCIL
Road Design Section,
Aras an Chonrae, Roscommon.
Phone 090 66 37100
C.E.O. and Director of Service: Mr. Eugene Cummins.

